

Before using this unit, carefully read the sections entitled: "USING THE UNIT SAFELY" and "IMPORTANT NOTES" (supplied on a separate sheet). After reading, keep the document(s) where it will be available for immediate reference.



https://muzcentre.ru

Main Features

The Graphic Equalizer GE-7 adjusts the harmonic contents of an instrument or microphone in seven separate bands. It covers the frequency spectrum for electric bass, electric guitar, keyboard, mic, etc., to adjust them for room acoustic or to accent a particular tone range. Each control adjusts a slightly expanded octave to yield 15 dB of cut or boost. The first three bands adjust the fundamental and the higher four bans adjust the strength of the harmonic accent. In addition level control is very useful for the balance effect sound.

Panel Descriptions

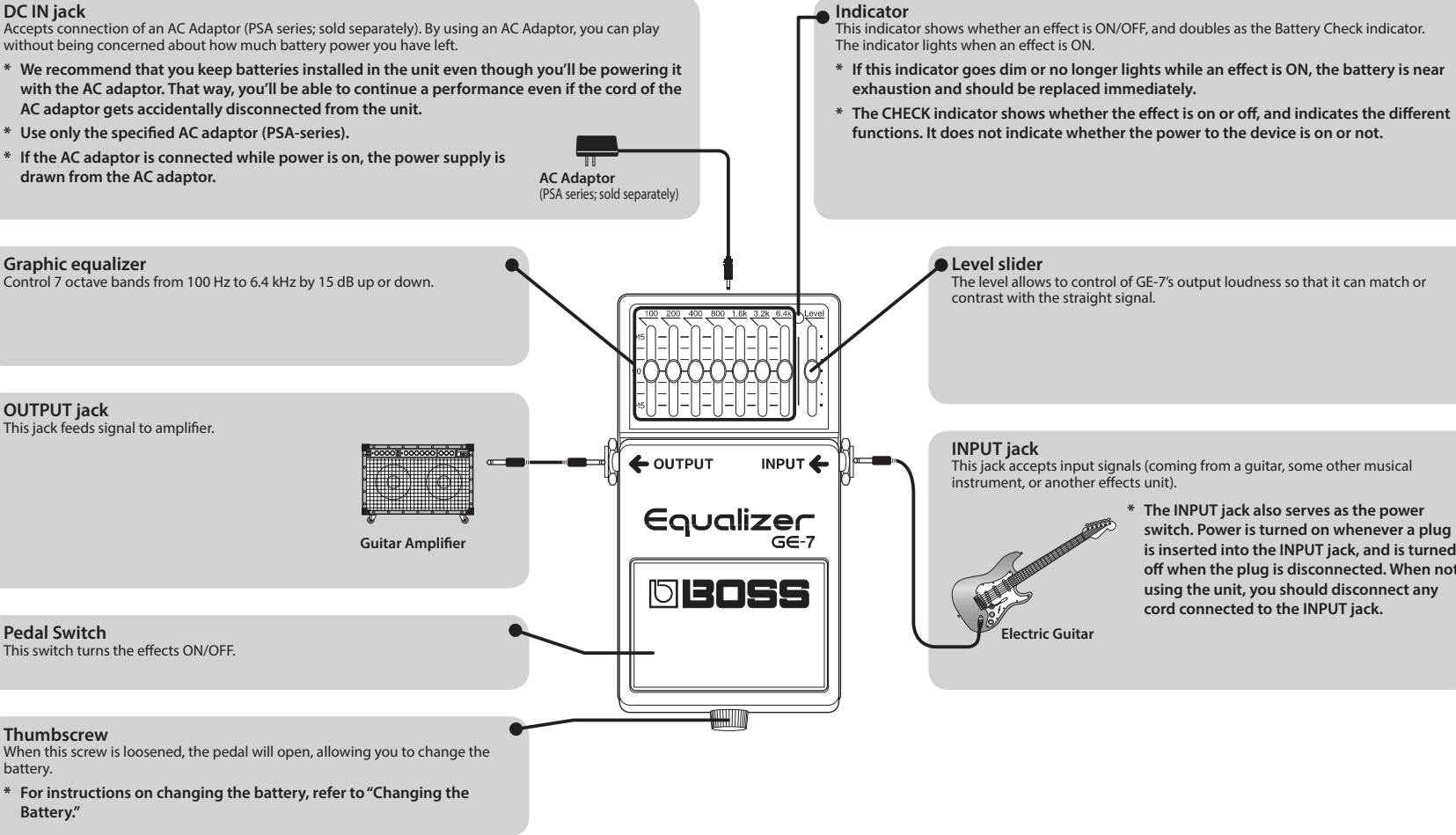

Precautions When Connecting

- * To prevent malfunction and equipment failure, always turn down the volume, and turn off all the units before making any connections.
- * Once the connections have been completed, turn on power to your various devices in the order specified. By turning on devices in the wrong order, you risk causing malfunction and/or damage to speakers and other devices.
When powering up: Turn on the power to your guitar amp last.
When powering down: Turn off the power to your guitar amp first.
- * Before turning the unit on/off, always be sure to turn the volume down. Even with the volume turned down, you might hear some sound when switching the unit on/off. However, this is normal and does not indicate a malfunction.

Operating the Unit

1. After connecting all cords required, set all knobs on the panel as illustrated.
2. Depress the pedal switch CHECK LED lights to indicate "EFFECT ON" and extinguishes to indicate "EFFECT OFF."
 - * This CHECK LED is also used to check battery. If LED fails to light or becomes dim, the battery should be replaced.
3. Set Graphic Equalizer sliders to proper position.
4. While switching pedal ON and OFF, set Level slider to proper position so no volume difference between Normal and Effect modes is notices.

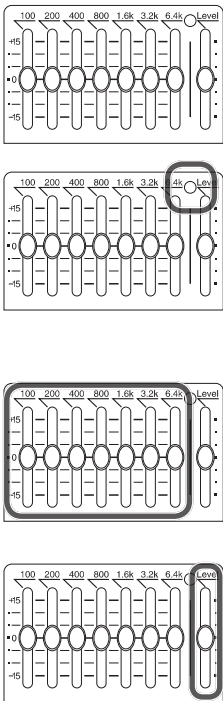

Use of Battery

- * A battery was installed in the unit before it left the factory. The life of this battery may be limited, however, since its primary purpose was to enable testing.
- * If you handle batteries improperly, you risk explosion and fluid leakage. Make sure that you carefully observe all of the items related to batteries that are listed in "USING THE UNIT SAFELY" and "IMPORTANT NOTES" (supplied on a separate sheet).
- * When operating on battery power only, the unit's indicator will become dim when battery power gets too low. Replace the battery as soon as possible.
- * Batteries should always be installed or replaced before connecting any other devices. This way, you can prevent malfunction and damage.

Changing the Battery

1. Hold down the pedal and loosen the thumbscrew, then open the pedal upward.
 - * The pedal can be opened without detaching the thumbscrew completely.
2. Remove the old battery from the battery housing, and remove the snap cord connected to it.
3. Connect the snap cord to the new battery, and place the battery inside the battery housing.
 - * Be sure to carefully observe the battery's polarity (+ versus -).
4. Slip the coil spring onto the spring base on the back of the pedal, and then close the pedal.
 - * Carefully avoid getting the snap cord caught in the pedal, coil spring, and battery housing.
5. Finally, insert the thumbscrew into the guide bush hole and fasten it securely.

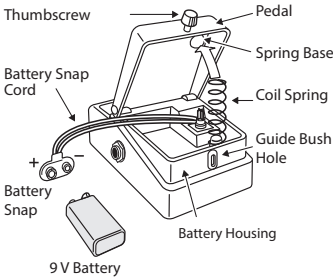

Main Specifications

BOSS GE-7: Equalizer	
Nominal Input Level	-20 dBm
Input Impedance	470 kΩ
Nominal Output Level	-20 dBm
Output Impedance	1 kΩ
Recommended Load Impedance	10 kΩ or greater
Power Supply	DC 9 V: Dry battery 6F22 (9 V) type (carbon), AC Adaptor (PSA-series: optional)
Current Draw	10 mA <ul style="list-style-type: none">* Expected battery life under continuous use: Carbon: Approx. 37 hours Alkaline: Approx. 67 hours These figures will vary depending on the actual conditions of use.
Dimensions	73 (W) x 129 (D) x 59 (H) mm 2-7/8 (W) x 5-1/8 (D) x 2-3/8 (H) inches
Weight	450 g/1 lb (including battery)
Accessories	Owner's Manual, Leaflet ("USING THE UNIT SAFELY," "IMPORTANT NOTES," and "Information"), Dry battery/9 V type (6F22)
Options	AC adaptor (PSA-series)

- * 0 dBu = 0.775 Vrms
- * This document explains the specifications of the product at the time that the document was issued. For the latest information, refer to the Roland website.